

Field Functional Tests

You *must* perform a field functional test after any of the procedures in this chapter are performed. The applicable test is specified after each section in this chapter. Appendix D, Field Functional Tests, contains complete test instructions.

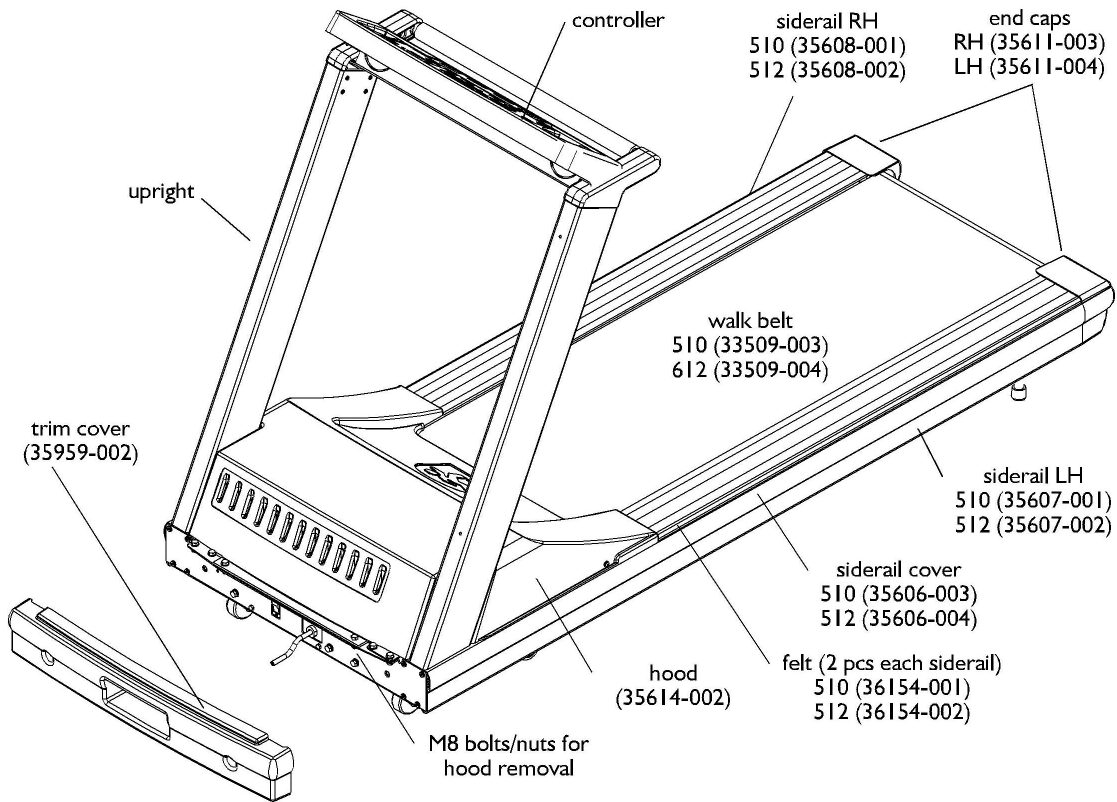

The VSD PCBA generates high voltage, which is present whenever DS4 and DS5 are illuminated. Do not touch the VSD PCBA until DS4 and DS5 have gone out. Resistors on the PCBA bleed off the high voltage in approximately two minutes.



Removing Treadmill Hood

1. For your convenience in working, elevate the treadmill to its maximum height if possible.
2. Turn off the circuit breaker on the treadmill and unplug the treadmill from the power outlet.



To prevent high voltage electrical shock: Before working on or around any electrical or mechanical component under the hood, wait at least two minutes from the time you unplug the power cord.

International units: Disconnect the power cord from the configuration plate.